

2026 RYKER RALLY



PACKAGE HIGHLIGHTS

- Go off the beaten path
- Designed for fun with access to new playgrounds
- Unique rugged style
- Authentic all-road rally experience



ENGINE	
Rotax® 900 ACE™	
Type	Rotax® 900 ACE™ in-line 3 cylinders, liquid-cooled with electronic fuel injection and electronic throttle control
Bore & stroke	74 x 69.7 mm (2,9 x 2,7 in.)
Power	82 hp (61.1 kW) @ 8000 RPM
Torque	58.3 lb-ft (79.1 Nm) @ 6500 RPM
CO ₂ emissions	143 g/km
Fuel consumption	6.08 l/100 km (38.7 mpg)
TRANSMISSION	
Type	Automatic (CVT) with reverse function
CHASSIS	
Front suspension	Double wishbone
Front shock type/travel	KYB HPG with remote reservoir 4-positions compression adjustable damping and preload adjustment / 185 mm (7.28 in.)
Rear suspension	Multi-link - mono swing arm
Rear shock type/travel	KYB HPG with remote reservoir 4-positions compression adjustable damping and preload adjustment / 179 mm. (7.05 in.)
Electronic brake distribution system	Foot-operated, hydraulic 3-wheel brake
Front brakes	270 mm discs with Nissin 2-piston floating calipers
Rear brake	220 mm disc, 1-piston floating caliper
Parking brake	Park lock
Front tires	XPS Rally - 145/60 R16 MC 66T
Rear tire	XPS Rally - 205/55 R15 MC 81T
Aluminum front rims	15-spoke, Hyper Silver, 406 x 114 mm. (16 x 4.5 in.)
Aluminum rear rim	15-spoke, Hyper Silver, 381 x 165 mm. (15 x 6.5 in.)
CAPACITY	
Rider capacity	1
Maximum vehicle load	187 kg (412.2 lb)
Storage capacity	7 L. (1.85 gal)
Fuel capacity	20 L. (5.28 gal)
Fuel type	Premium unleaded

DIMENSIONS	
L x W x H	2,532 x 1,522 x 1,090 mm (92.6 X 59.9 X 42.9 in.)
Wheelbase	1,709 mm (67.3 in.)
Seat height	676 mm (26,6 in.)
Ground clearance	122 mm (4.8 in.)
Dry weight	303 kg (668 lb)

INSTRUMENTATION	
Type	4.5 in. digital display
Main functions	Speedometer, tachometer, odometer, trips, distance to empty, engine lights, fuel gauge, clock, ECO mode and Rally mode

SAFETY & SECURITY	
SCS	Stability Control System
TCS	Traction Control System
ABS	Anti-lock Braking System
Anti-theft system	Digitally Encoded Security System (D.E.S.S.™)
HHC	Hill Hold Control

COVERAGE	
Factory warranty	2-year BRP Limited Warranty
Extended service terms	2-year roadside assistance provided by Allianz Assistance, world leader in Automotive and Travel assistance, on behalf of BRP*

FEATURES	
<ul style="list-style-type: none">• 2 halogen headlamps (55 W)• Front fenders with integrated LED lights• Dual USB port• Glove box (1.8 gal / 7 l.)• Rally mud flaps• MAX Mount Structure• Cruise control• Rally mode• Rally comfort seat	<ul style="list-style-type: none">• Handguards• Akrapovič exhaust• Rally handlebar• Adjustable large anti-slip foot pegs• Front suspension protection• Skid plate• Air intake with pre-filter• Front grille protection• Reinforced rims

*Available on vehicles registered by an authorized BRP dealer in the United Kingdom, Ireland, France, Netherlands, Belgium, Luxembourg, Germany, Austria, Switzerland, Italy, Spain or Portugal.





*In the UK, you can ride Can-Am 3-Wheel vehicles with a car licence (B) from the age of 21 years old. In Norway, Finland and Sweden, you can ride Can-Am 3-Wheel vehicles with a car licence (B) under certain conditions. More details on A and B licence requirements at canamonroad.com/licence. For all other countries, please ask your local authority.

FEATURE HIGHLIGHTS



AKRAPOVIČ EXHAUST

Unique sound signature and high-end exhaust.



FULL KYB® HPG SHOCKS

Front and rear KYB HPG shocks with remote adjusters and 1 inch of extra suspension travel to optimize your ride and improve comfort.



MAX MOUNT STRUCTURE

Makes the unit 1+1 ready. It also increases the carrying capacity for different storage options.



INCREASED VEHICLE PROTECTION

Get extra protection for higher durability with front vehicle protection, skid plate under the vehicle and reinforced rims.



UNIQUE RALLY EXPERIENCE

A vehicle designed for all-road trips with hand guards, Rally comfort seat for a more reactive rider position, mud flaps and large anti-slip adjustable foot pegs.



RALLY MODE AND TIRES

Allows you to have more flexibility and fun off-pavement by optimizing VSS input and enabling you to perform controlled drifts with adapted all-road tires

Classic series¹



Intense Black



Adrenaline Red



Yellow Shock

Epic series



Immortal White



Liquid Steel

Exclusive series²



Heritage White IV



Heritage Yellow



Icepop Blue

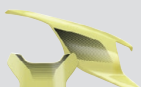

Lemon Twist

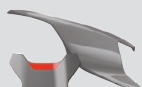

Silver Lava



Sonic Silver



Purple Galaxy

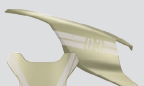

Sandstorm

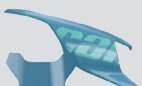

Blue Abyss

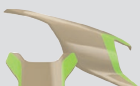

Goblin Green

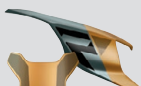

Atlantis Gold



Urban Blue



Cyber Orange

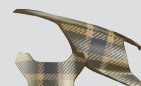

Moka Plaid

New panels



Peachy Frenzy



Cotton Candy



Crimson Rush

¹Choice of one set of Classic Panels included at the vehicle purchase. ²Exclusive Panel Kits are available in limited quantities.