

# 2026 RYKER SPORT



### PACKAGE HIGHLIGHTS

- Exciting & thrilling rideExciting & thrilling ride
- Designed for fun
- Bold sport styling
- Added comfort and convenience



ENGINE		Rotax® 900 ACE™
Type	Rotax® 900 ACE™ in-line 3 cylinders, liquid-cooled with electronic fuel injection and electronic throttle control	
Bore & stroke	74 x 69.7 mm (2,9 x 2,7 in.)	
Power	82 hp (61.1 kW) @ 8000 RPM	
Torque	58.3 lb-ft (79.1 Nm) @ 6500 RPM	
CO <sub>2</sub> emissions	143 g/km	
Fuel consumption	6.08 l/100 km (38.7 mpg)	
TRANSMISSION		
Type	Automatic (CVT) with reverse function	
CHASSIS		
Front suspension	Double wishbone	
Front shock type/travel	KYB† HPG with preload adjustment 161 mm (6.34 in.)	
Rear suspension	Multi-link - mono swing arm	
Rear shock type/travel	KYB HPG with remote reservoir 4-positions compression adjustable damping and preload adjustment / 169 mm. (6.65 in.)	
Electronic brake distribution system	Foot-operated, hydraulic 3-wheel brake	
Front brakes	270 mm discs with Nissin 2-piston floating calipers	
Rear brake	220 mm disc, 1-piston floating caliper	
Parking brake	Park lock	
Front tires	XPS Ride - 145/60 R16 MC 66T	
Rear tire	XPS Ride - 205/45 R16 MC 77T	
Aluminum front rims	5-spoke, Deep Black, machined and tinted, 406 x 114 mm (16 x 4.5 in.)	
Aluminum rear rim	5-spoke, Deep Black, machined and tinted, 406 x 165 mm. (16 x 6.5 in.)	
CAPACITY		
Rider capacity	1	
Maximum vehicle load	199 kg (438.7 lb)	
Storage capacity	7 L. (1.85 gal)	
Fuel capacity	20 L. (5.28 gal)	
Fuel type	Premium unleaded	

DIMENSIONS	
L x W x H	2,352 x 1,522 x 1,073 mm (92.6 x 59.9 x 42.2 in.)
Wheelbase	1,709 mm (67.3 in.)
Seat height	629 mm (24,7 in.)
Ground clearance	101 mm (4.0 in.)
Dry weight	291 kg (642 lb)

INSTRUMENTATION	
Type	4.5 in. digital display
Main functions	Speedometer, tachometer, odometer, trips, distance to empty, engine lights, fuel gauge, clock, ECO mode and Sport mode.

SAFETY & SECURITY	
SCS	Stability Control System
TCS	Traction Control System
ABS	Anti-lock Braking System
Anti-theft system	Digitally Encoded Security System (D.E.S.S.™)
HHC	Hill Hold Control

COVERAGE	
Factory warranty	2-year BRP Limited Warranty
Extended service terms	2-year roadside assistance provided by Allianz Assistance, world leader in Automotive and Travel assistance, on behalf of BRP*

FEATURES	
	<ul style="list-style-type: none"><li>• 2 halogen headlamps (55 W)</li><li>• Front fenders with integrated LED lights</li><li>• Dual USB port</li><li>• Glove box (1.8 gal / 7 l.)</li><li>• Full rear fender</li><li>• MAX Mount Structure</li><li>• Cruise control</li><li>• Sport mode</li><li>• Sport comfort seat</li><li>• Sport style trims and finishes</li></ul>

\*Available on vehicles registered by an authorized BRP dealer in the United Kingdom, Ireland, France, Netherlands, Belgium, Luxembourg, Germany, Austria, Switzerland, Italy, Spain or Portugal.





\*In the UK, you can ride Can-Am 3-Wheel vehicles with a car licence (B) from the age of 21 years old. In Norway, Finland and Sweden, you can ride Can-Am 3-Wheel vehicles with a car licence (B) under certain conditions. More details on A and B licence requirements at [canamonroad.com/licence](https://canamonroad.com/licence). For all other countries, please ask your local authority.

## FEATURE HIGHLIGHTS



### CRUISE CONTROL

No need to keep the throttle at all times, the cruise control can be switched on to maintain a selected constant speed.



### KYB† HPG SHOCKS

KYB HPG shocks with remote adjusters on the rear for different riding experiences.



### MAX MOUNT STRUCTURE

Makes the unit 1+1 ready. It also increases the carrying capacity for different storage options.



### SPORT MODE

Allows you to have more fun on paved roads. Sport mode loosens the traction control of the rear wheel enabling you to perform controlled drifts



### DRIVESHAF

Highly durable and robust driveshaft technology will help you enjoy a smooth ride all along the way. No need for further adjustment, alignment or maintenance.



### SPORT STYLE TRIMS AND FINISHES

Modern design with a sleeker look for sport style enthusiasts.

### Classic series<sup>1</sup>



Intense Black



Adrenaline Red



Yellow Shock

### Epic series



Immortal White



Liquid Steel

### Exclusive series<sup>2</sup>



Heritage White IV



Heritage Yellow



Icepop Blue

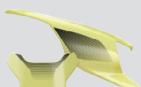

Lemon Twist

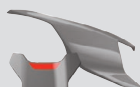

Silver Lava



Sonic Silver



Purple Galaxy

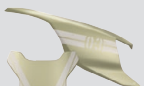

Sandstorm

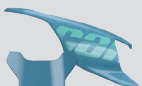

Blue Abyss



Goblin Green

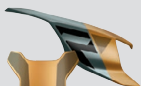

Atlantis Gold



Urban Blue



Cyber Orange

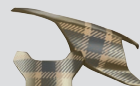

Moka Plaid

### New panels



Peachy Frenzy



Cotton Candy



Crimson Rush

<sup>1</sup>Choice of one set of Classic Panels included upon vehicle purchase. <sup>2</sup>Exclusive Panel Kits are available in limited quantities.